

Optional Floodlighting Brackets (Bullhorns)

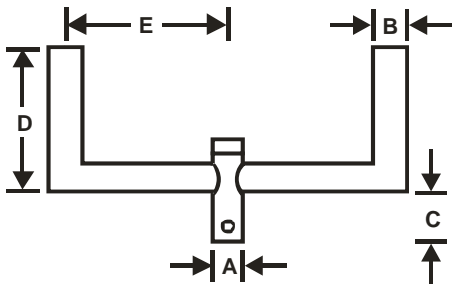

V-2

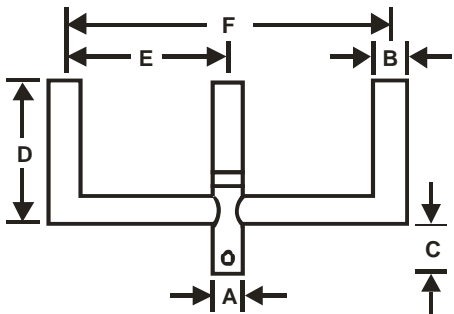

V-3

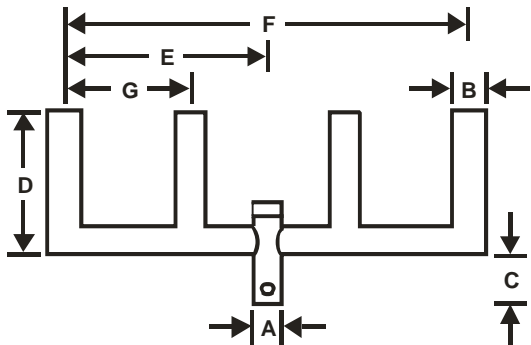

V-4

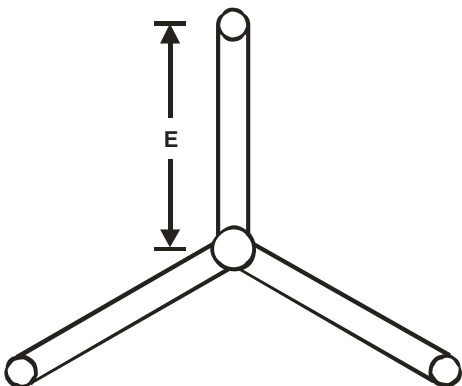

V-3-120

Bullhorn Number	Dimensions (in inches)						
	A(id)	B(od)	C	D	E	F	G
V-2	2.5	2.375	6	8	18	36	
V-3	2.5	2.375	6	8	24	48	
V-3-120	2.5	2.375	6	8	18		
V-4	2.5	2.375	6	8	24	48	12
V-4-90	2.5	2.375	6	8	18	36	

Bullhorn Number	Area sq. ft.	EPA	Weight lbs.
V-2	0.98	0.89	19
V-3	1.70	1.55	25
V-3-120	1.41	1.29	27
V-4	1.44	1.31	27
V-4-90	1.84	1.68	35

EPA ASCE 98, 80 mph, 1.3 gust, Exp. C

Standard Finish

Powder coating is the standard finish. Charged particles are applied to the surface. The finish is then baked on providing superior durability.

WARNING

This information is intended as a general guideline only. The customer is solely responsible for the proper selection of the pole, luminaire, accessories, and foundation for the site conditions and intended usage. Mounting items, in addition to the luminaire will impact the EPA load on the pole. A qualified professional should be consulted to analyze the load to ensure proper selection of the pole, luminaire, accessories, and foundation. Valley Nut and Bolt Company, Inc. assumes no responsibility for such analysis or product selection. Failure to ensure proper site analysis, pole selection, loads and installation can result in pole failure, leading to serious injury or property damage.

How to select the proper pole

1. Determine the max. wind velocity in your area as indicated on the national wind velocity map.
2. Add the EPA's of the desired luminaire(s) and mounting bracket(s) to determine the total.
3. Select a pole with an EPA that is sufficient for the wind velocity and the total of the luminaire(s) and mounting bracket(s).

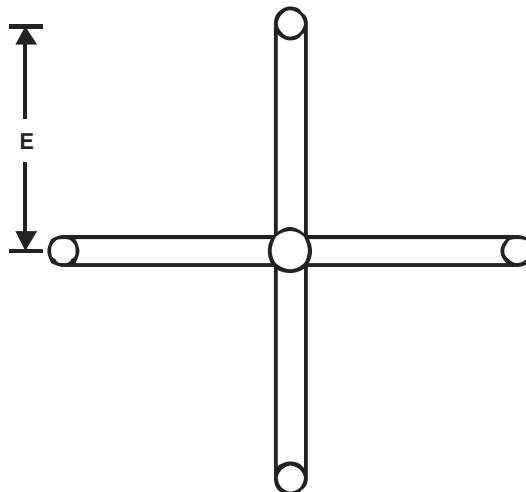

V-4-90